

## LONG-TERM CARE

# NURSES' STATION

A Nurses' Station is an area of a Long-Term Care Facility which nurses and other health care staff work behind when not working directly with Residents. The station has a counter that can be approached by Residents, staff and visitors who wish to receive attention from nurses.

The nurses' stations not only carry out administrative tasks, but also handle clinically associated functions that have impact on the delivery of care to the residents.

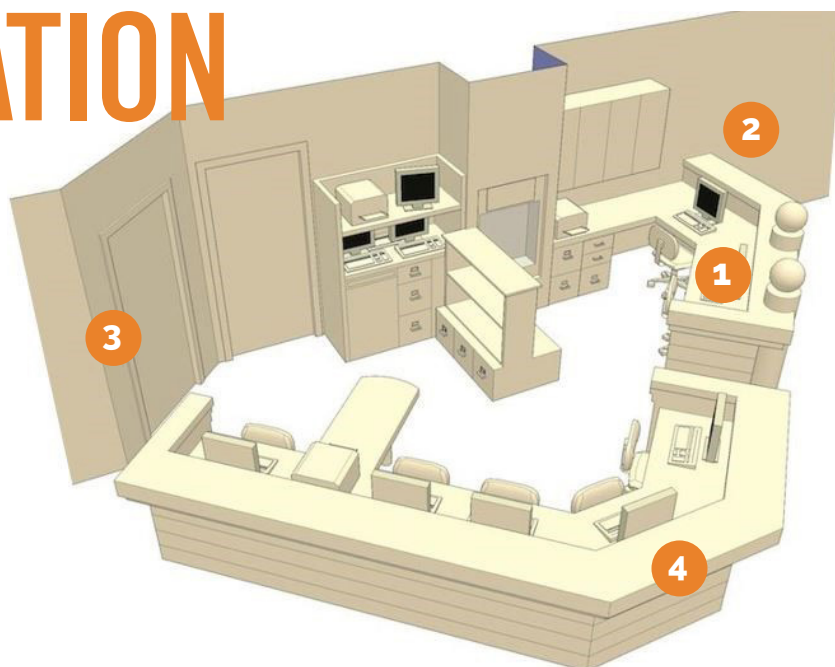

# PARTNERS IN PROTECTION

## STOP THE SPREAD

The following protocols are key to maximize health and safety and break the chain of transmission in the Nurses' Station.



1

### No Sharing

Office personnel should not share equipment like phones, computers, copiers, and staplers to reduce the risk of infection.



2

### Staff Lounge

Before and after using appliances in the staff lounge, a staff member should use a wipe to disinfect the appliance and "touched" objects.



3

### Hand Hygiene

The Nurses' Station should always have a wall mounted hand sanitizer dispenser as well as an adequate supply of hand soap.



4

### Sick Residents

All horizontal surfaces, especially those that may have been touched by a sick Resident, must be disinfected.



## PERSONAL RESPONSIBILITY

Ensure there is a hand sanitizer dispenser at a central location in the area where the offices are located. Let individuals know they will be responsible for their own area. Each staff member should use a wipe when they first enter their office. Having staff members wipe their own furniture and office equipment negates the need to wipe multiple times and means an Environmental Services professional will not need to disinfect the items on a nightly basis.

## VISITING THE NURSE

- Set a disinfection protocol and ensure the nurse is effectively trained on the process and safety.
- The nurse should use disinfecting wipes or chemical disinfectant and microfiber cloths.
- The nurse is required to wash/sanitize her/his hands before and after taking care of a student.
- Ensure wipes and disinfectants that are used are appropriate for use on medical equipment.
- Isolation curtains are recommended to separate sick Residents from each other.